

THE

VALLEY VIEW

(LOFT SERIES)



THE VALLEY VIEW LOG HOME PACKAGE INCLUDES:

• LOG WALL SYSTEM

- Pre-cut wall logs
- 12" lags and saturated foam gasket
- 1/2" log wall rods with springs
- Assembly prints
- Base board trim and log siding for subfloor band boards

• WINDOW & DOOR FRAMING SYSTEM

- Pre-cut, window and door jambs
- Interior and exterior 1" trim lumber

• LOFT FRAMING SYSTEM

- Pre-cut loft joists
- Pre-cut girder beams
- 6" x 6" support posts with adjusters
- Installation hardware

• ROOF FRAMING SYSTEM

- Pre-cut rafters and ridge beams
- Support posts and rafter collar ties
- Pre-cut dormer headers, sills, and support posts
- Log siding for gable ends and dormers

• PORCH FRAMING SYSTEM

- Pre-cut plates and rafters
- 6" x 6" pressure treated foundation, support posts and sills
- Pre-cut pressure treated 2" x 8" joists and 5/4" decking

• TRIM LUMBER

- Surfaced trim lumber for gable ends, dormers, fascia, and porch eaves

- **OPTIONS:** 2" x 6" or 2" x 8" T & G flooring and sheeting, and rigid insulation



CATCH CABIN FEVER!

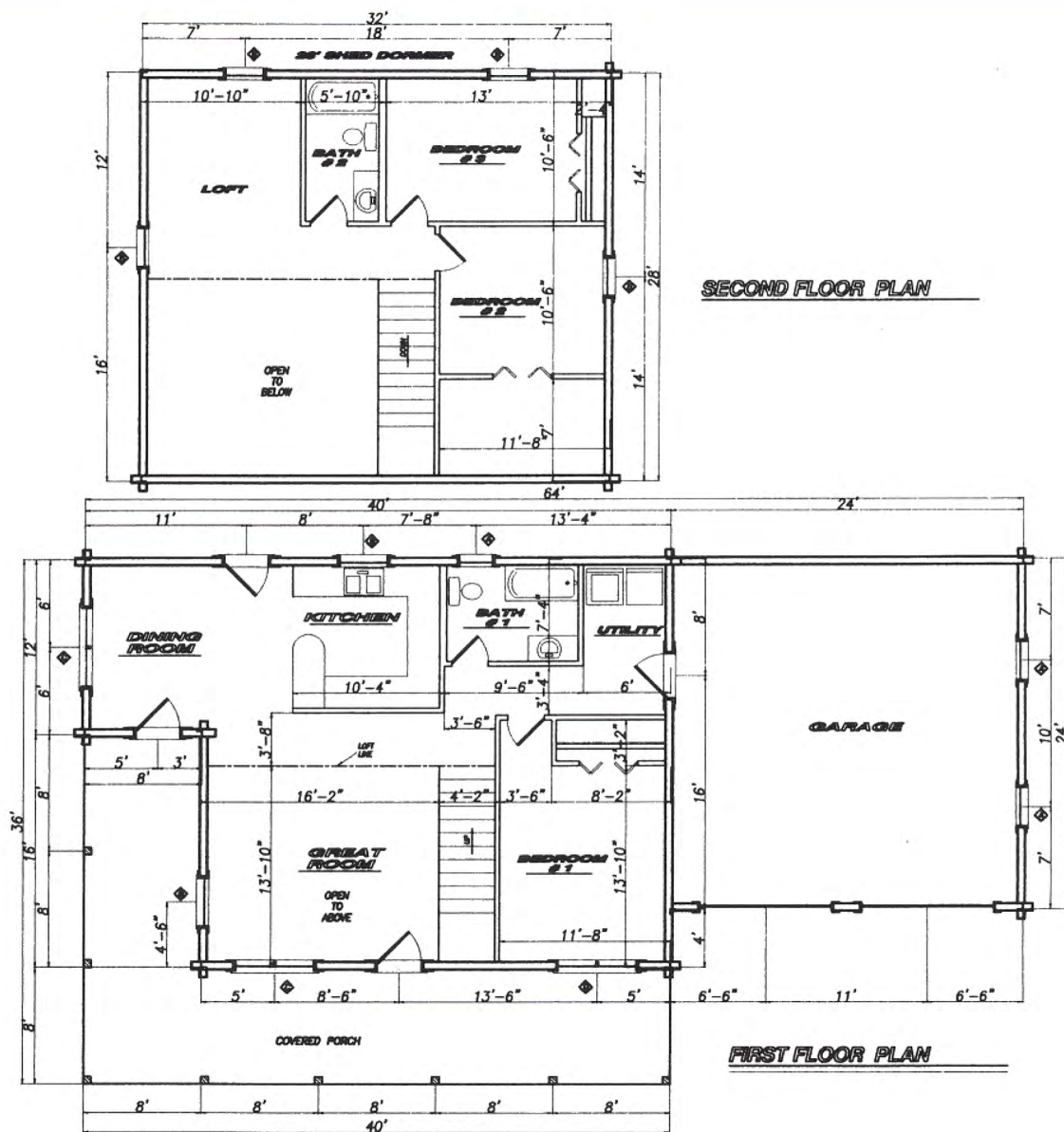

THE VALLEY VIEW

- 28' x 40' (with Optional Garage)
- 1608 Sq. Ft. Living Area
- 992 Sq. Ft. First Floor
- 616 Sq. Ft. Second Floor
- 24' x 24' Garage - 576 Sq. Ft. optional
- 56' Wrap Around Porch

