

THE

TWIN PINES

(RENTAL SERIES)



THE TWIN PINES LOG HOME PACKAGE INCLUDES:

• LOG WALL SYSTEM

- Pre-cut wall logs
- 12" lags and saturated foam gasket
- 1/2" log wall rods with springs
- Assembly prints
- Base board trim and log siding for subfloor band boards

• WINDOW & DOOR FRAMING SYSTEM

- Pre-cut, window and door jambs
- Interior and exterior 1" trim lumber

• ROOF SYSTEM BY OWNER

• PORCH FRAMING SYSTEM

- Pre-cut plates and rafters
- 6" x 6" pressure treated foundation, support posts and sills
- Pre-cut pressure treated 2" x 8" joists and 5/4" decking

• TRIM LUMBER

- Surfaced trim lumber for gable ends, dormers, facia, and porch eaves

• OPTIONS: 2" x 6" T & G for Porch Roof



CATCH CABIN FEVER!

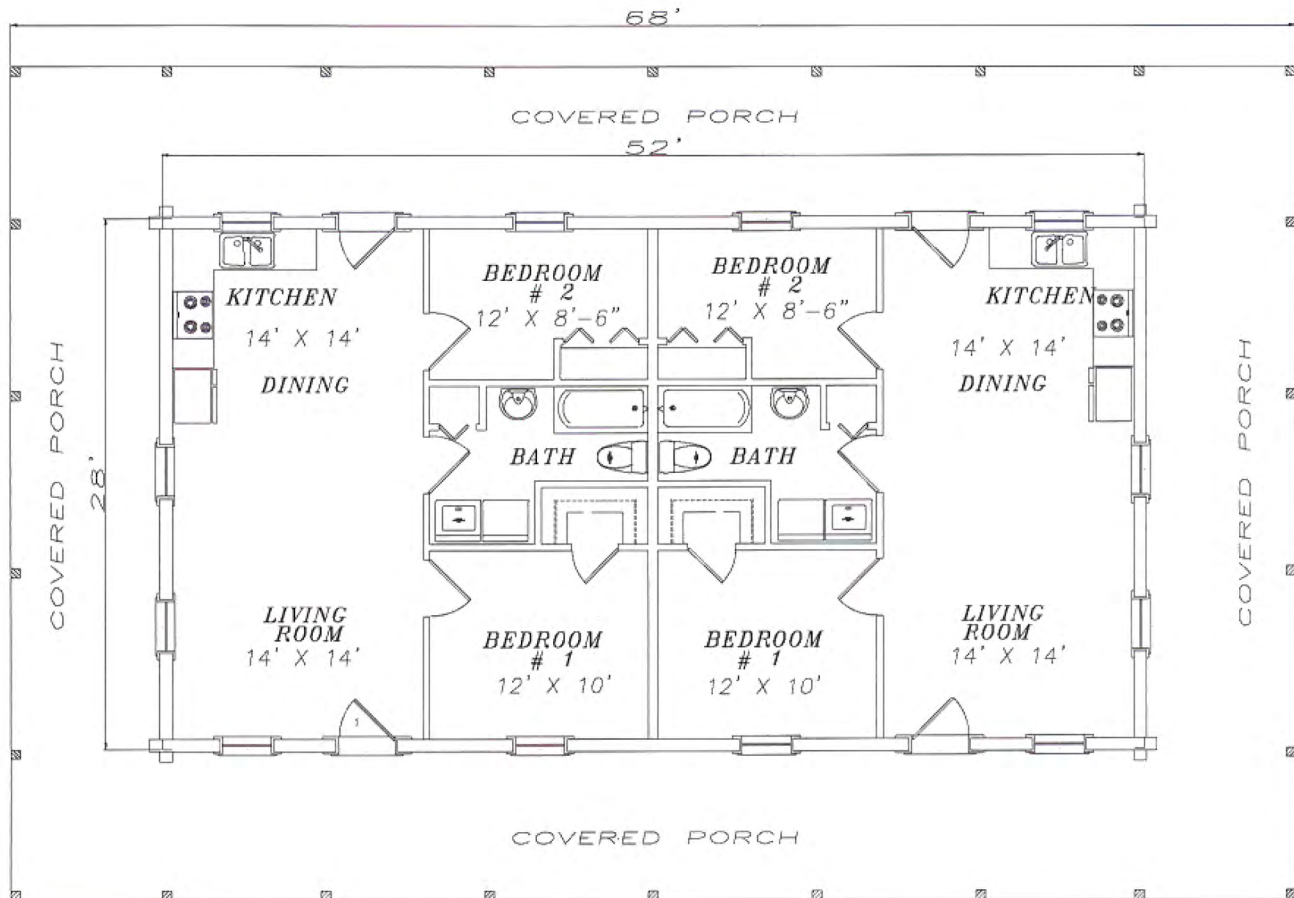

THE TWIN PINES

- 28' x 52'
- 1456 Sq. Ft. Living Area
- 8' x 192' Porches

