

THE

LODGE *at* SYCAMORE CREEK

(RENTAL SERIES)



THE LODGE AT SYCAMORE CREEK LOG HOME PACKAGE INCLUDES:

• LOG WALL SYSTEM

- Pre-cut wall logs
- 12" lags and saturated foam gasket
- 1/2" log wall rods with springs
- Assembly prints
- Base board trim and log siding for subfloor band boards

• WINDOW & DOOR FRAMING SYSTEM

- Pre-cut, window and door jambs
- Interior and exterior 1" trim lumber

• LOFT FRAMING SYSTEM

- Pre-cut loft joists
- Pre-cut girder beams
- 6" x 6" support posts with adjusters
- Installation hardware

• TRUSS ROOF SYSTEM

- Center section cathedral ceiling - rafters provided
- Wing sections - trussed roof systems provided by owner

• ROOF FRAMING SYSTEM

- Pre-cut rafters and ridge beams
- Support posts and rafter collar ties
- Pre-cut dormer headers, sills, and support posts
- Log siding for gable ends and dormers

• PORCH FRAMING SYSTEM

- Pre-cut plates and rafters
- 6" x 6" pressure treated foundation, support posts and sills
- Pre-cut pressure treated 2" x 8" joists and 5/4" decking

• TRIM LUMBER

- Surfaced trim lumber for gable ends, dormers, fascia, and porch eaves

- **OPTIONS:** 2" x 6" or 2" x 8" T & G flooring and sheeting and rigid insulation



CATCH CABIN FEVER!

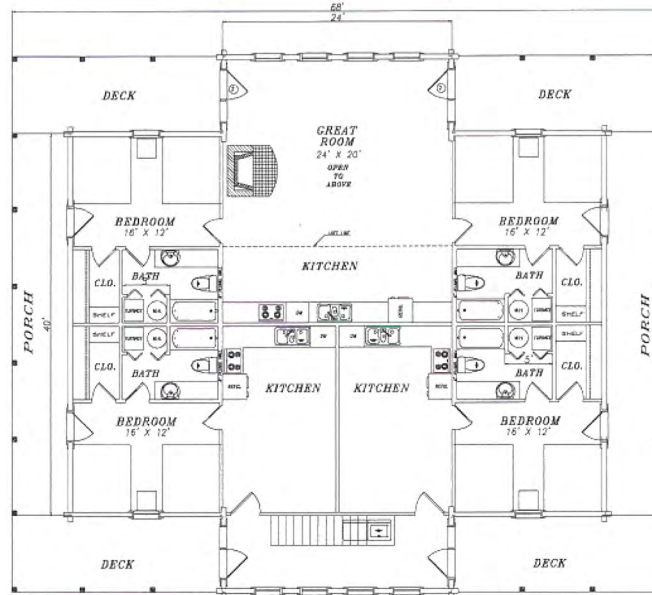
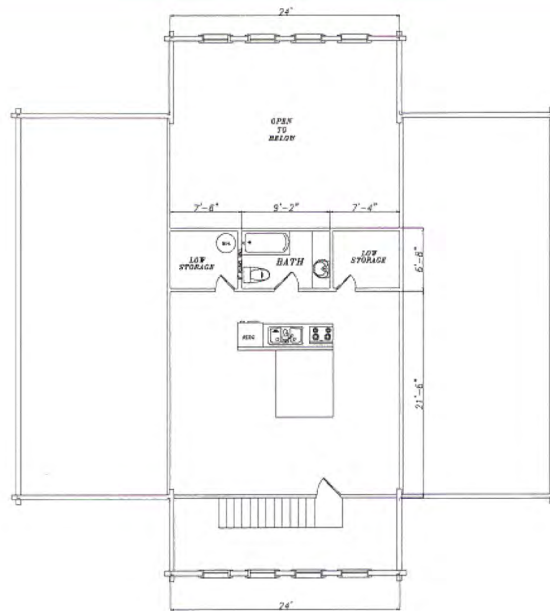

THE LODGE *at* SYCAMORE CREEK

- 56' x 56' "T"
- 3296 Sq. Ft. Living Area
- 2 - 6' x 40' Porches
- 4 - 8' x 16' Deck Optional
- Optional 512 Sq. Ft. Second Floor
(Box Truss Over Bedrooms)

