

# THE FORESTVIEW

(CABIN SERIES)



## THE FORESTVIEW LOG HOME PACKAGE INCLUDES:

### • LOG WALL SYSTEM

- Pre-cut wall logs
- 12" lags and saturated foam gasket
- 1/2" log wall rods with springs
- Assembly prints
- Base board trim and log siding for subfloor band boards

### • WINDOW & DOOR FRAMING SYSTEM

- Pre-cut, window and door jambs
- Interior and exterior 1" trim lumber

### • ROOF SYSTEM BY OWNER

### • PORCH FRAMING SYSTEM

- Pre-cut plates and rafters
- 6" x 6" pressure treated foundation, support posts and sills
- Pre-cut pressure treated 2" x 8" joists and 5/4" decking

### • TRIM LUMBER

- Surfaced trim lumber for gable ends, dormers, fascia, and porch eaves

- **OPTIONS:** 2" x 6" or 2" x 8" T & G flooring and sheeting, and rigid insulation



# CATCH CABIN FEVER!



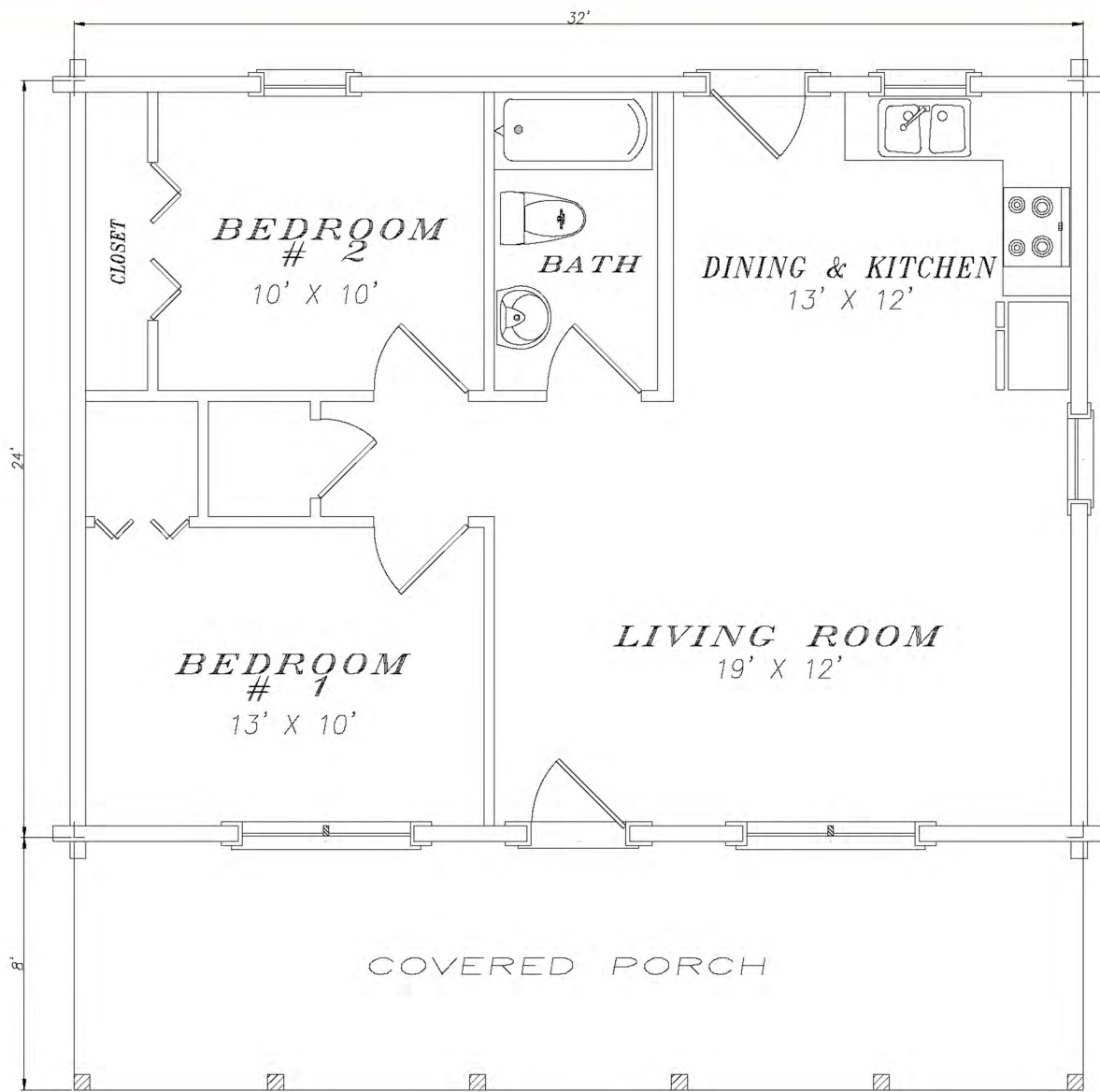

# THE FORESTVIEW

- 24' x 32'
- 768 Square Feet Living Area
- 8' x 32' Porch

